

Step 1:

Install Dowel & Cam Lock Screw on Left Panel & Right Panel;

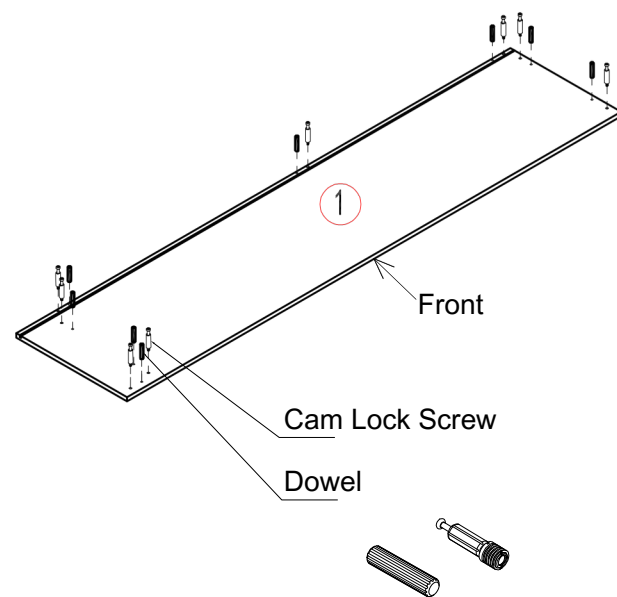

Step 2:

Insert Top Panel, Bottom Panel & 3" Panel on Right Panel; Lock tight with Cam Lock;

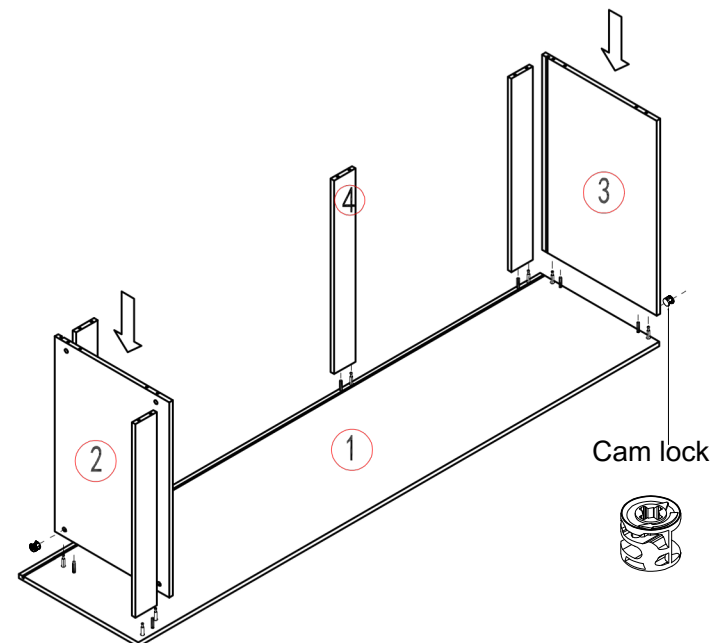

Step 5:

Install Fixing nail (6 pcs) in the back;

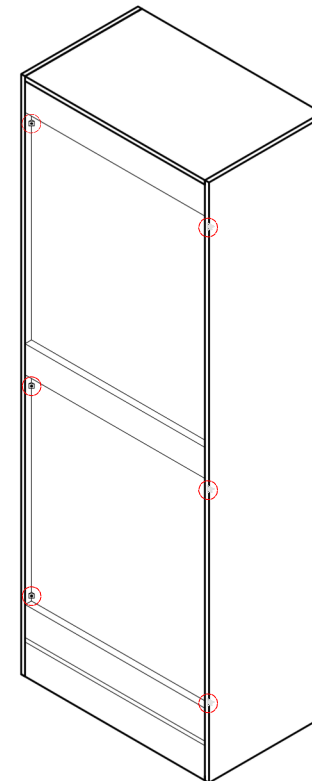

Step 3:

Insert Back Panel;

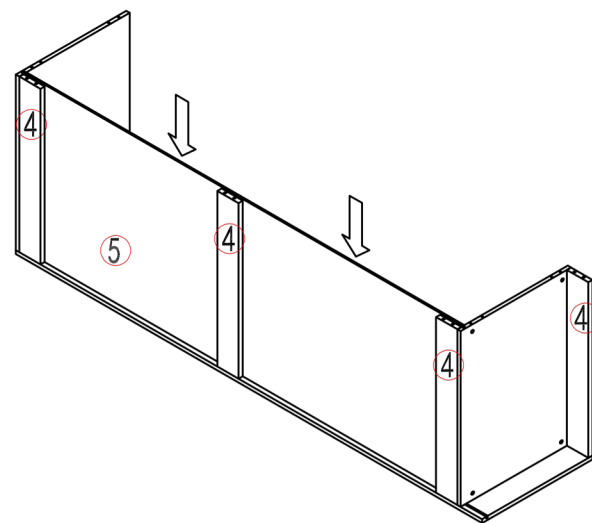

Step 4:

Cover Left Panel; Lock tight with Cam Lock;

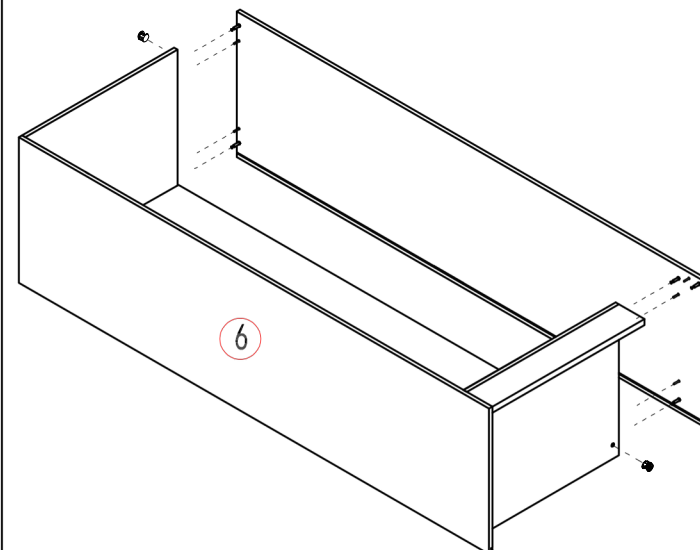

Step 6:

Stand the cabinet up; Insert the shelf support on Left Panel & Right Panel; Install shelf;

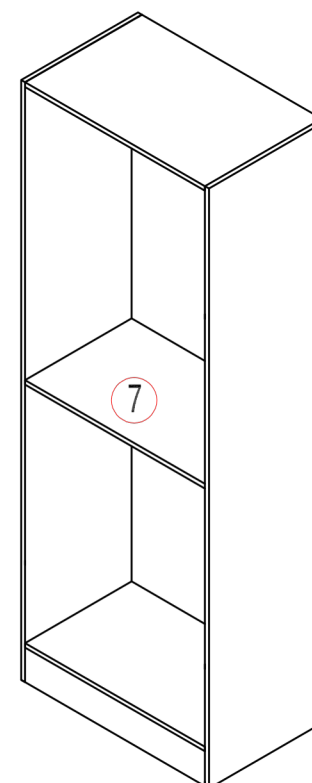

ASSEMBLY INSTRUCTION

No.	PICTURE	ITEM
1		Cam lock
2		Cam lock screw
3		Dowel
4		Shelf support

No.	Part	QTY.
1	Right panel	1
2	Bottom panel	1
3	Top panel	1
4	3'' Panel	4
5	Back panel	1
6	Left panel	1
7	Shelf	1
		total 10

C1884F
C2484F
C3084F
C3684F

Step 1:
Install Dowel & Cam Lock Screw
on Left Panel、Right Panel、
Back Panel 1 & Back Panel 2;

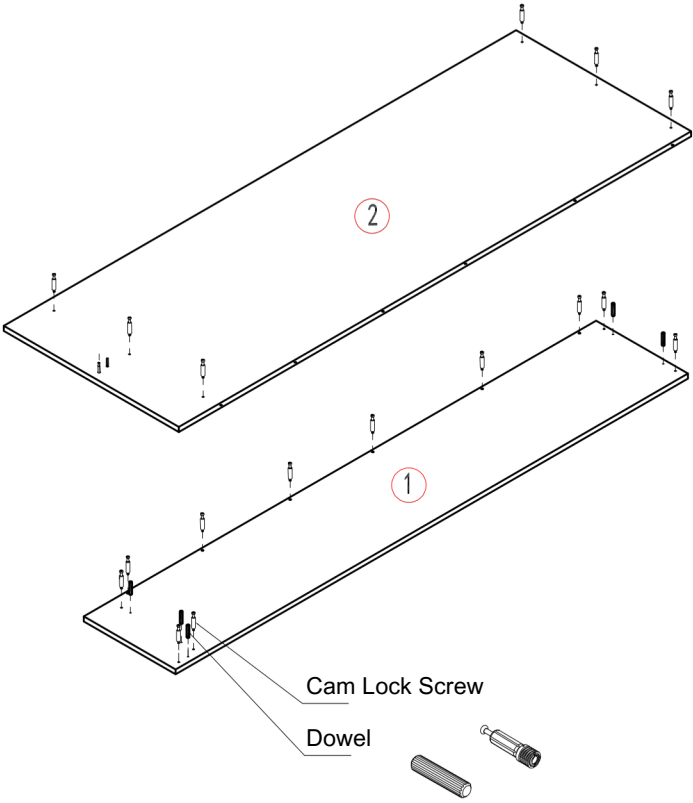

Step 2:
Insert Top Panel 、 Bottom Panel、
Toekick 1 & Toekick 2 on Back Panel 1,
Lock tight with Cam Lock;

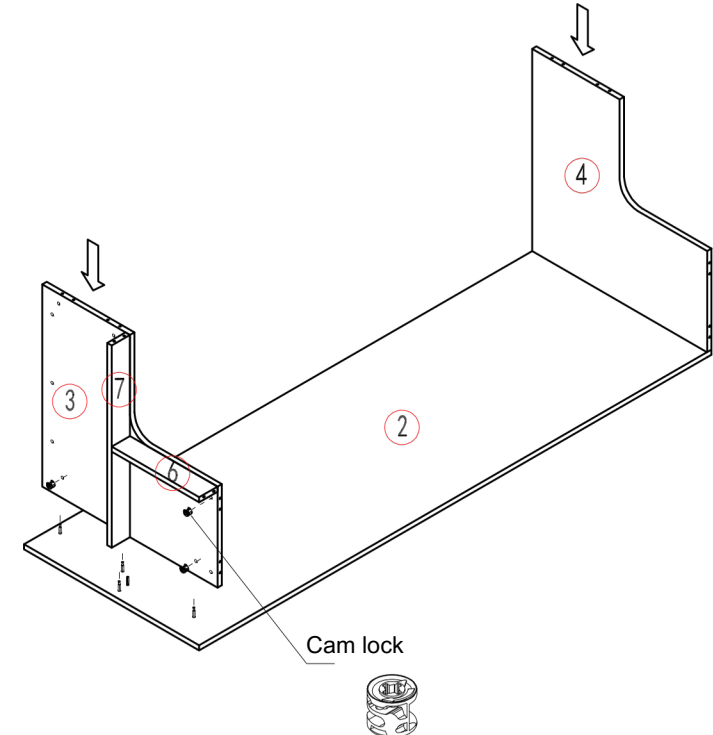

Step 5:
Stand the cabinet up;
Insert the shelf support on Left Panel
、 Right Panel、 Back Panel 1 &
Back Panel 2,Install shelf;

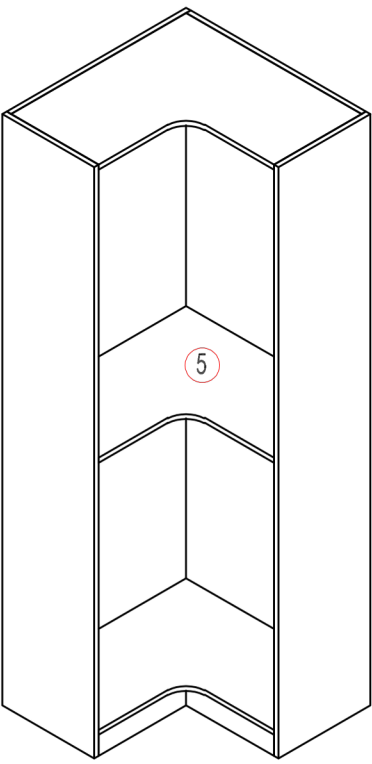

Step 3:
Cover Back Panel 2 & Right Panel,
Lock tight with Cam Lock;

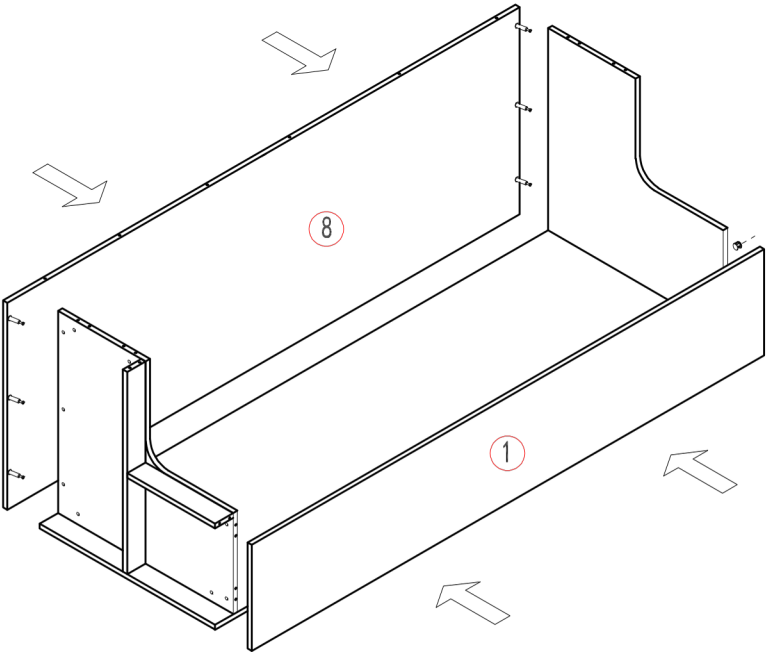

Step 4:
Cover Left Panel
Lock tight with Cam Lock;

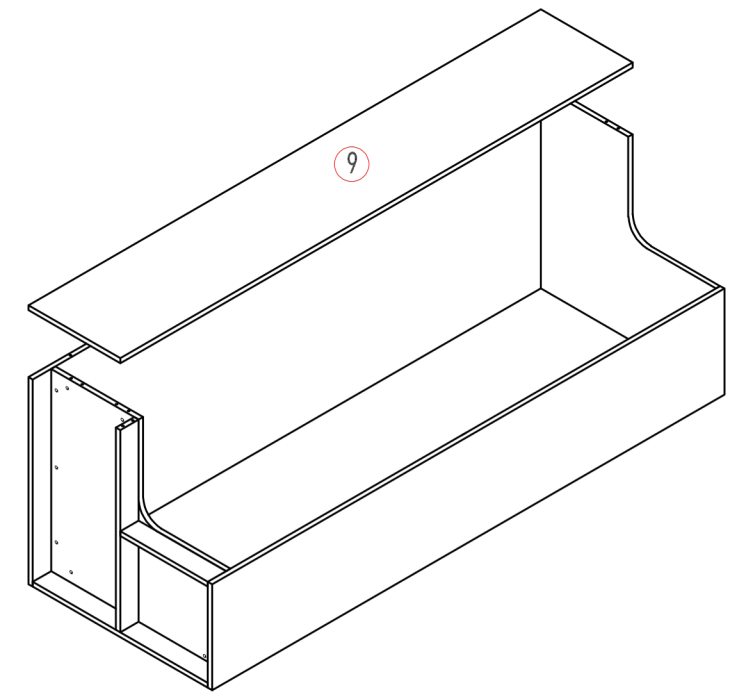

ASSEMBLY INSTRUCTION

No.	PICTURE	ITEM
1		Cam lock
2		Cam lock screw
3		Dowel
4		Shelf support

No.	Part	QTY.
1	Right panel	1
2	Back panel 1	1
3	Bottom panel	1
4	Top panel	1
5	Shelf	1
6	Toekick 1	1
7	Toekick 2	1
8	Back panel 2	1
9	Left panel	1
		total 9

ER3084F
ER3684F

Step 1:
Install Dowel & Cam Lock Screw
on Left Panel & Right Panel;

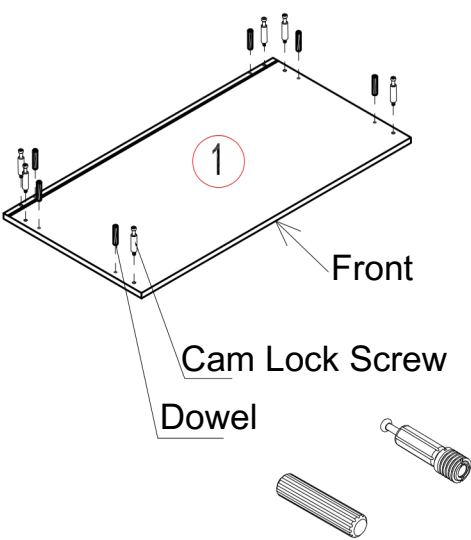

Step 2:
Insert Top Panel, Bottom Panel &
3" Panel on Right Panel;
Lock tight with Cam Lock;

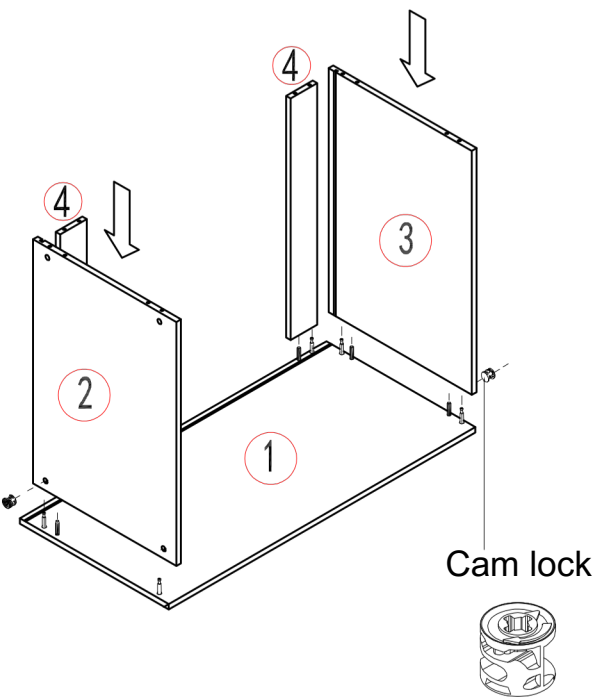

Finish

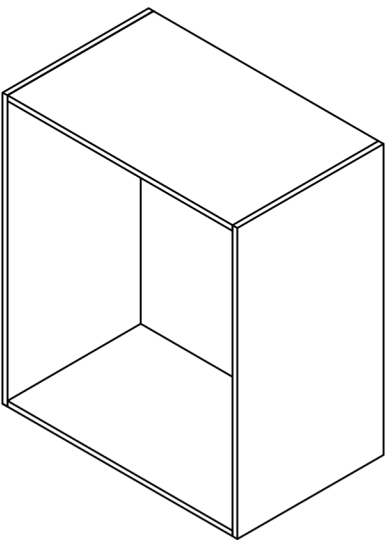

ASSEMBLY INSTRUCTION

No.	PICTURE	ITEM
1		Cam lock
2		Cam lock screw
3		Dowel
No.	Part	QTY.
1	Right panel	1
2	Bottom panel	1
3	Top panel	1
4	3'' Panel	2
5	Back panel	1
6	Left panel	1
		total 7

Step 3:
Insert Back Panel;

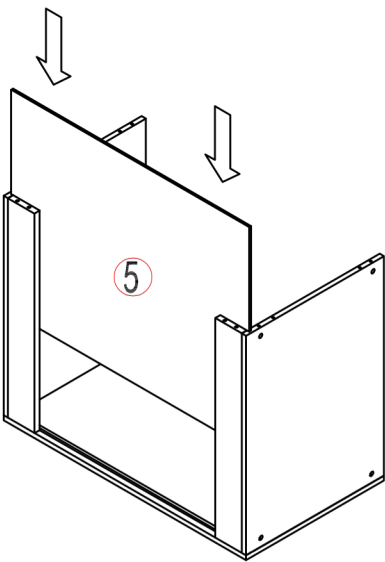

Step 4:
Cover Left Panel
Lock tight with Cam Lock;

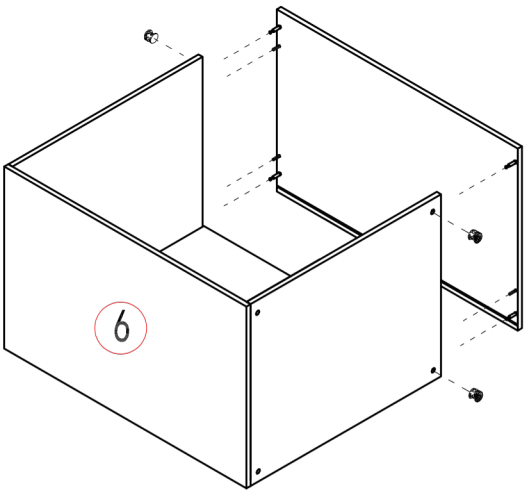

C3621

Step 1:
Install Cam Lock Screw on Left Panel & Right Panel;
Install Dowel on Front Panel & Bottom Panel;

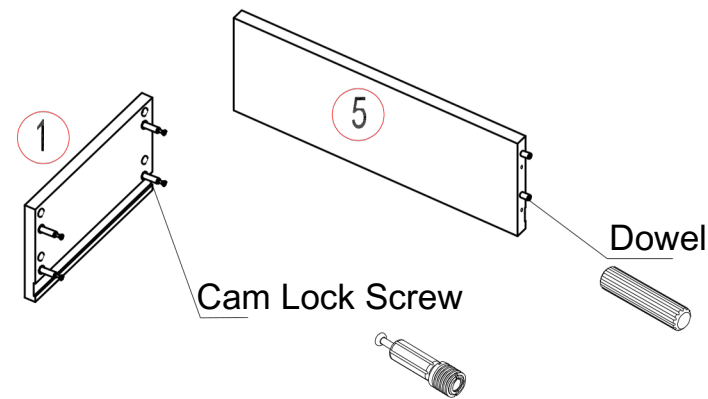

Step 2:
Connect Left Panel with Back Panel & Font Panel;
Lock tight with Cam Lock;

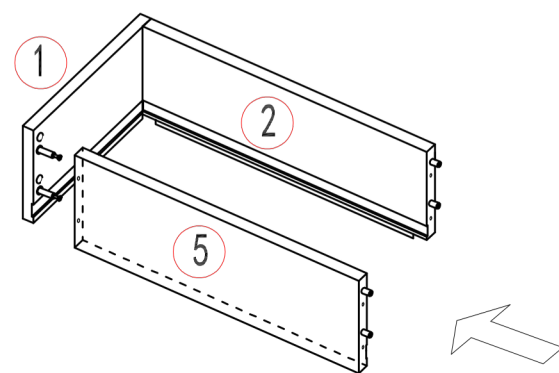

Step 3:
Insert Bottom Panel from right side;

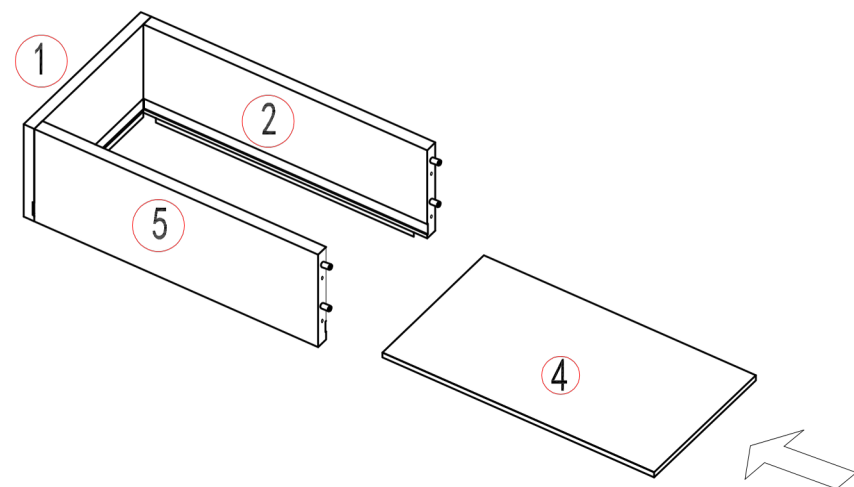

Step 4:
Cover Right Panel, Lock tight with Cam Lock;

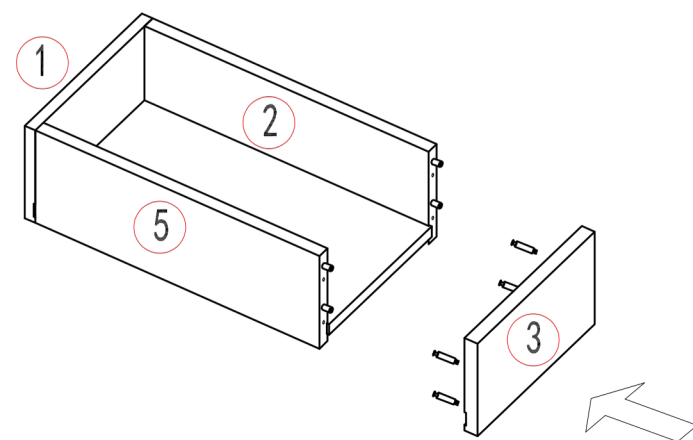

Step 5:
Install Drawer Face, Screw from inside of drawer box;

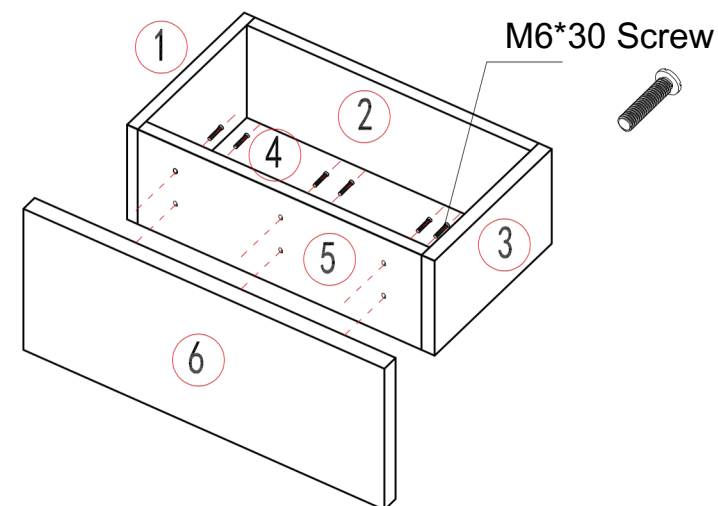

Finish;

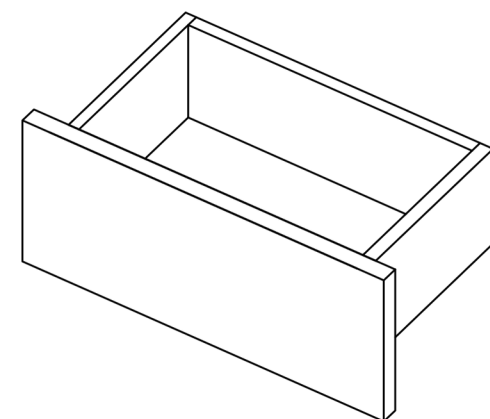

ASSEMBLY INSTRUCTION

No.	PICTURE	ITEM
1		Cam lock
2		Cam lock screw
3		Screw
4		Dowel

No.	Part	QTY.
1	Left panel	1
2	Back panel	1
3	Right panel	1
4	Bottom Panel	1
5	Front Panel	1
6	Drawer Face	1
		total 6

DK18S DK18B
DK24S DK24B
DK30S DK30B
DK36S DK36B

△How to Install Drawer?

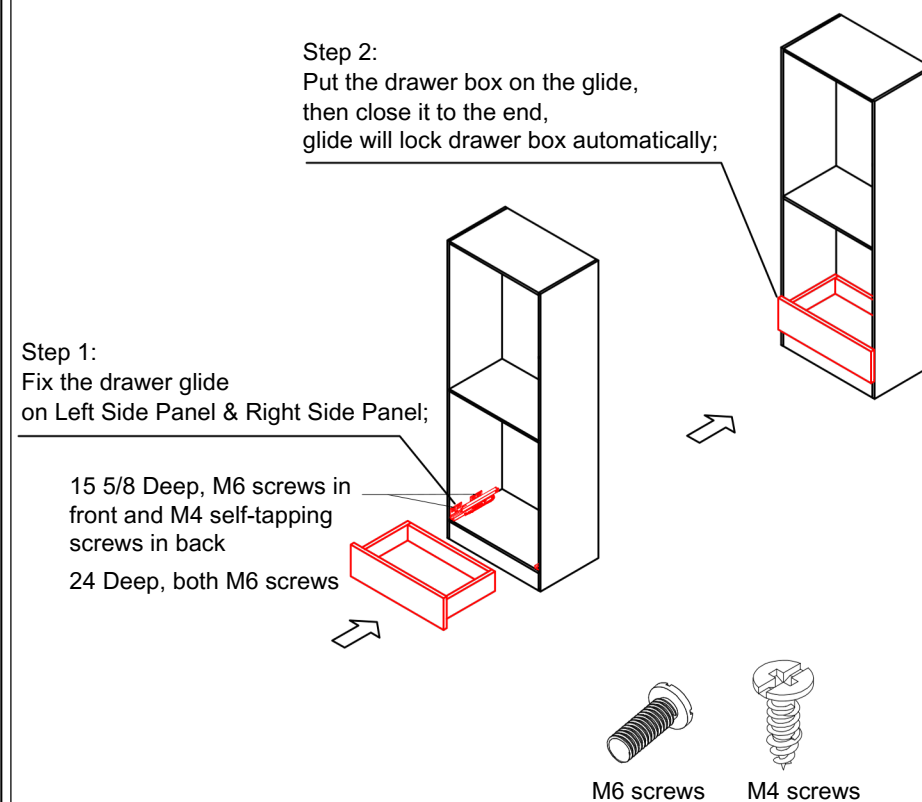

△How to Install Hanging ROD?

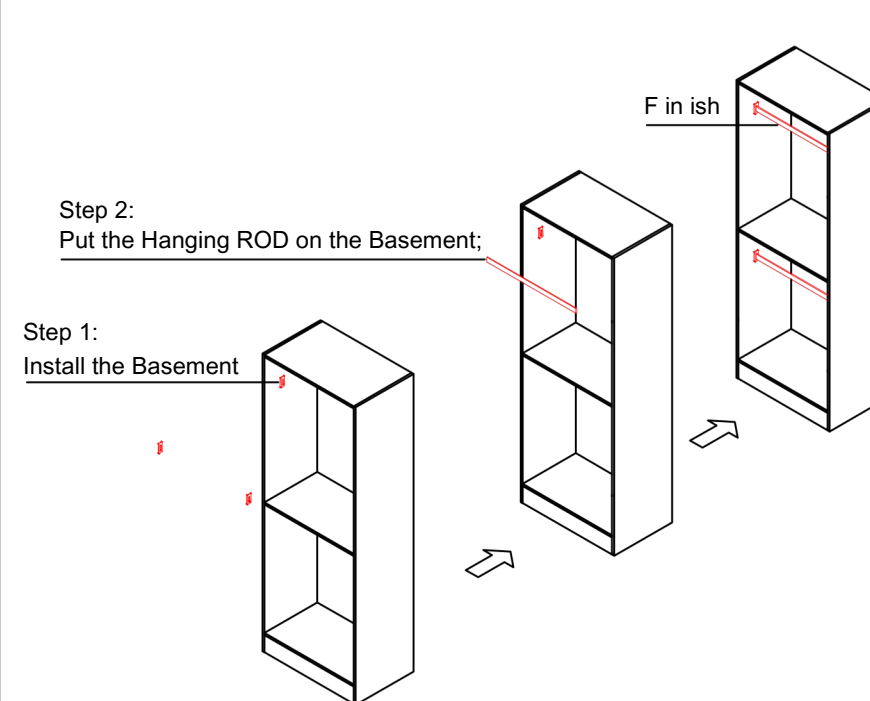

△How to Install LED LIGHTING?

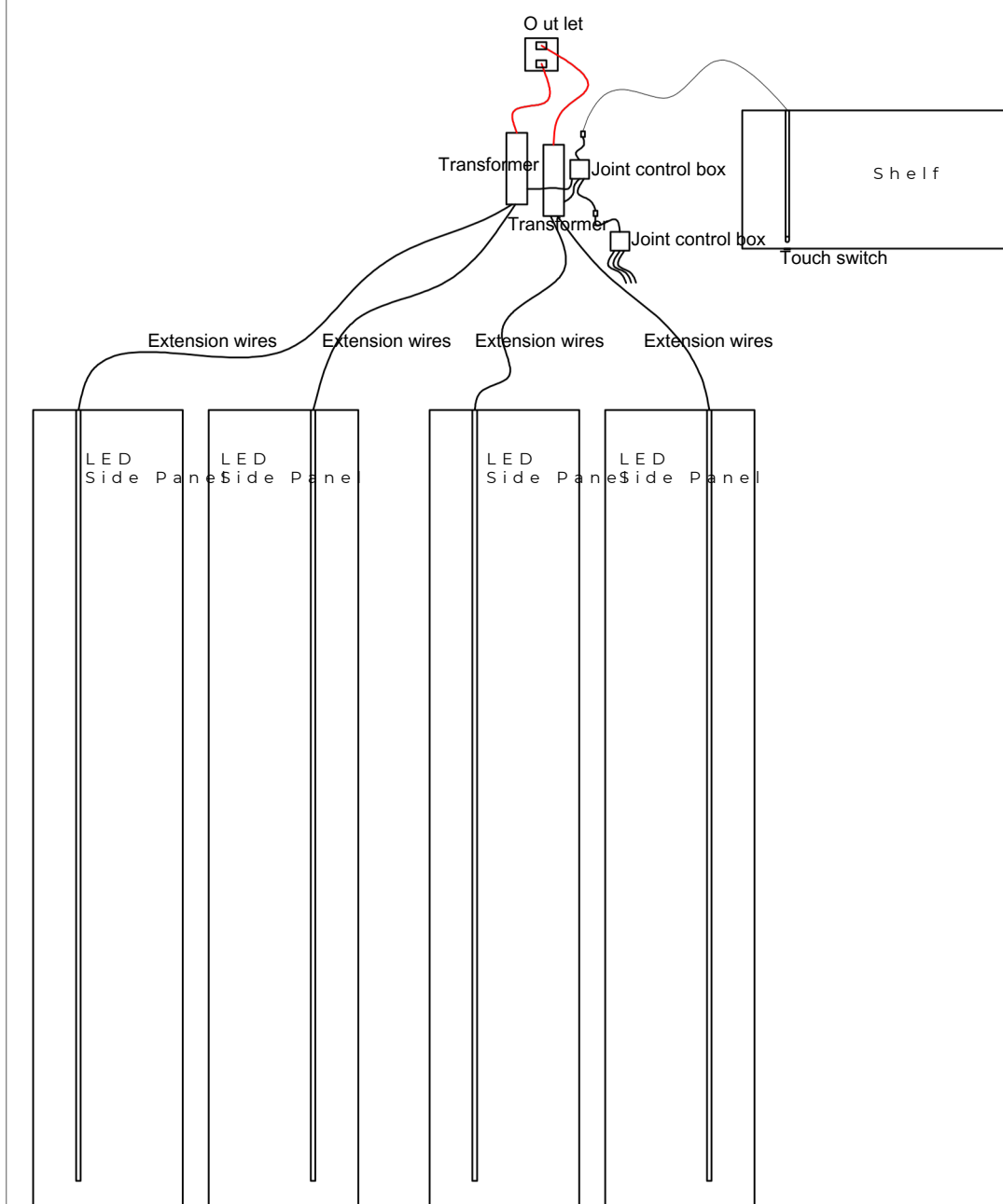

Step 1:
Connect LED LIGHTING to Transformer.
(Extension wires could be added when needed).

Step 2:
Connect Joint control box to Transformer.

Step 3:
Connect Touch switch to Joint control box.

△How to Install Shelf?

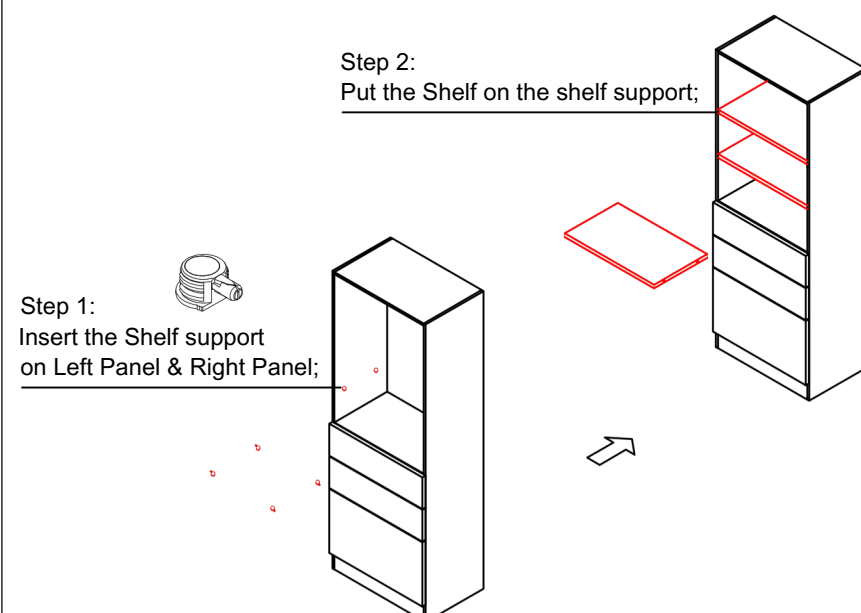

△How to Install Shoe Shelf?

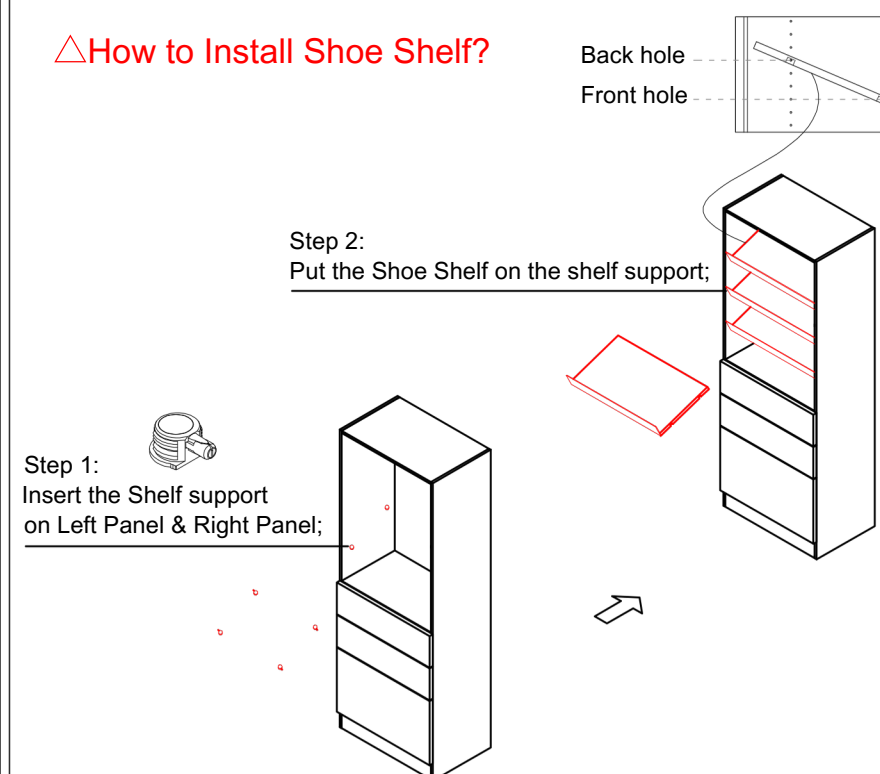

Fix the closet to the wall

Fix the closet to the wall with screws from the top inside.

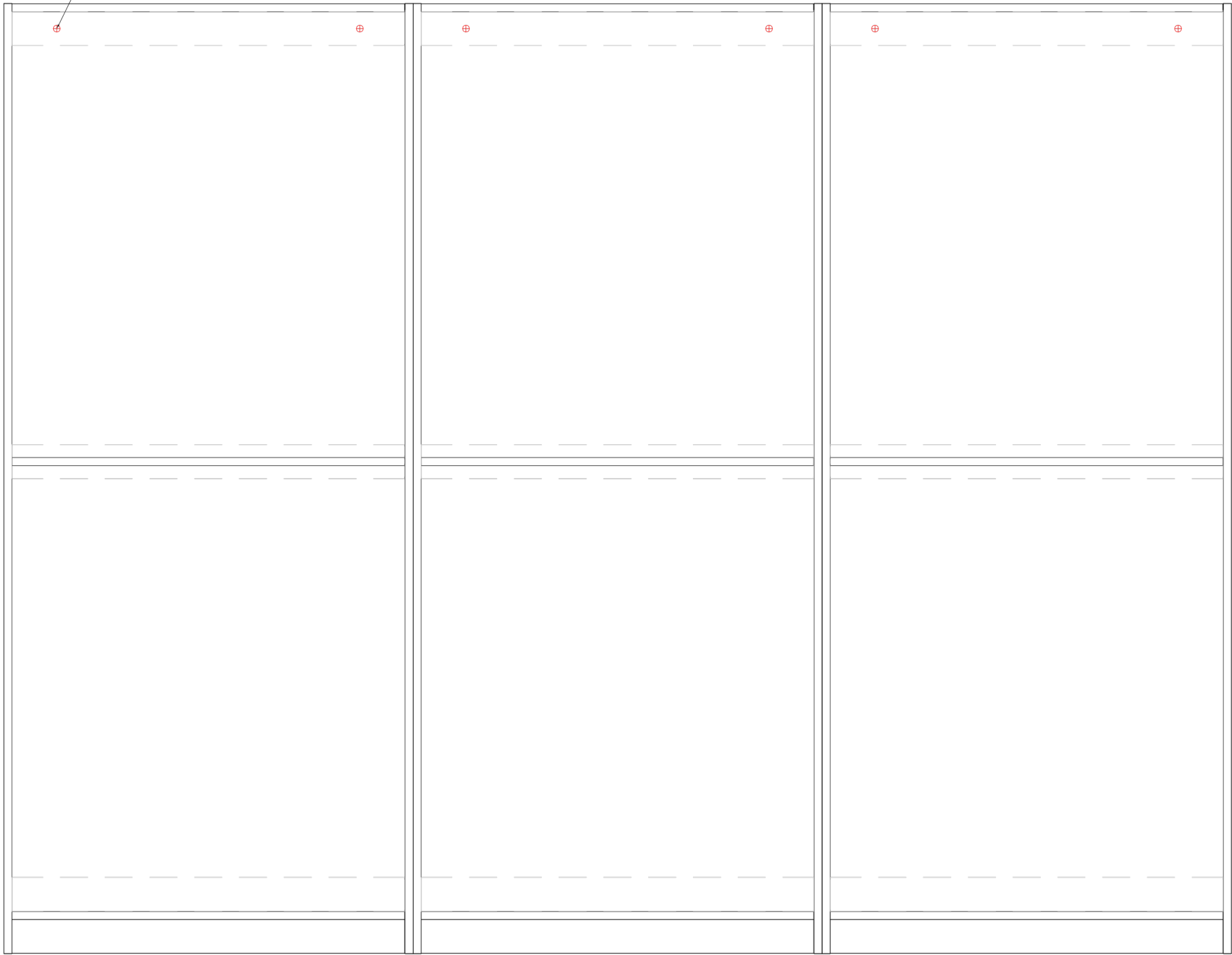

Elevation

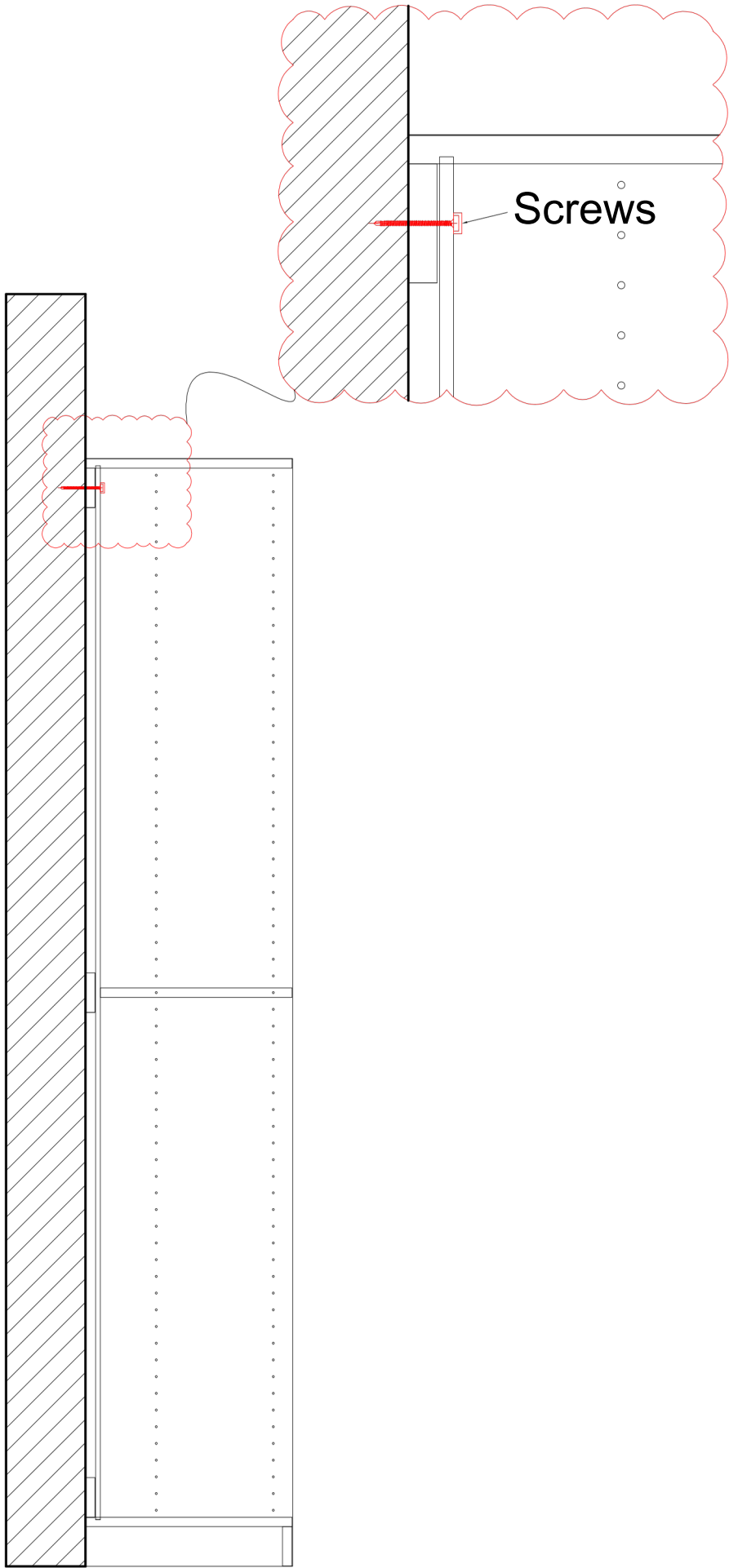

Section